

MPSI CONNEX 100-1000 Series 2.00mm (0.079") Pitch 2-Row Vertical, TH, PCB Header: 2A, PA6T UL94V-0, 2 to 80 Contacts. Order Code 100-1001-XX (See > Options)

| www.mpsiconnex.com | sales@mpsiconnex.com |

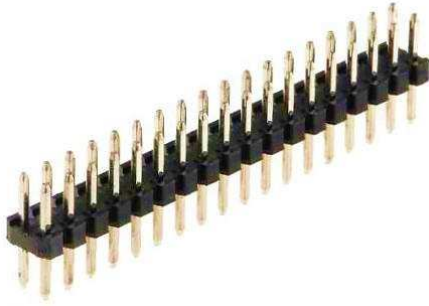

Images are for Illustrative Purposes Only

100-1000 Series Dual-Row 2.00mm Pitch Male Pin Headers.

Vertical PCB Mounting and Through-Hole Technology.

Rated at 2A, with Standard UL94V-0 (PA6T) Hi-Temp Insulator

Available Options (See > Options):

Number of Ways: 1 to 40 (2 to 80 Contacts)

Contact Plating

Insulator Materials

Custom Pin & Insulator Height

> TECHNICAL SPECIFICATION

PITCH:	2.00MM	
NUMBER OF ROWS:	2	
NUMBER OF WAYS:	1 to 40	(SEE > OPTIONS)
MOUNTING TYPE:	PCB THROUGH-HOLE	
ORIENTATION:	VERTICAL	
INSULATOR COLOUR:	BLACK	
INSULATION (PLASTICS):	PA6T UL94V-0 STANDARD	(SEE > OPTIONS)
CONTACT MATERIAL:	BRASS/COPPER ALLOY	
CONTACT PLATING:	GOLD FLASH STANDARD	(SEE > OPTIONS)
RoHS COMPLIANT:	YES	
CURRENT RATING:	2A	
CONTACT RESISTANCE:	20 mΩ MAX	
DIELECTRIC WITHSTANDING VOLTAGE:	500V AC	
INSULATION RESISTANCE:	1000MΩ	
OPERATING TEMPERATURE:	-40°C to +105°C	
MAX PROCESSING TEMP (PA6T):	230°C for 30-60 SECONDS (260°C 10 SECONDS)	

> OPTIONS

NUMBER OF WAYS:	-XX SUFFIX DESIGNATES NUMBER OF WAYS
INSULATOR MATLS: (PA6T POLYESTER HI TEMP AS STD NO SUFFIX)	<ul style="list-style-type: none"> -A PBT (UL94V-0) -B PA46 BLACK POLYAMIDE NYLON (UL94V-0) -C PA66 BLACK POLYAMIDE NYLON (UL94V-0) -D LCP BLACK (UL94V-0) -E PA9T BLACK POLYAMIDE NYLON (UL94V-0)
<p>CUSTOM PIN (PA) & INSULATOR (PB) HEIGHT:</p> <p>STD PIN (PA) HEIGHT = 3.9MM (NO SUFFIX)</p> <p>STD INSULATOR (PB) HEIGHT = 2.0MM (NO SUFFIX)</p> <p>OTHER INSULATOR (PB) HEIGHTS: 1.0MM & 1.5MM</p> <p><i>PLEASE ENQUIRE ON CUSTOM REQUIREMENTS</i></p>	<ul style="list-style-type: none"> -PA&VALUE(MM) -PB&VALUE(MM)
CONTACT PLATING: (GOLD FLASH AS STANDARD NO SUFFIX)	-G2 5U" GOLD
<p>PART NUMBER EXAMPLE: 100-1001-20-G2 = 20 WAY, 40 POS (20 x 2), HI-TEMP INSULATOR, 5U" PLATING</p> <p>PLEASE VERIFY AVAILABILITY ON OPTIONS PRIOR TO SELECTION / ORDERING</p>	

> PHYSICAL

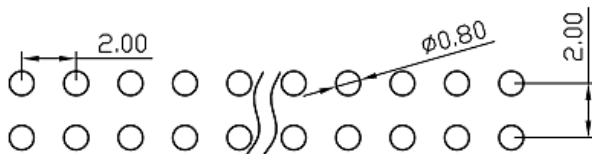
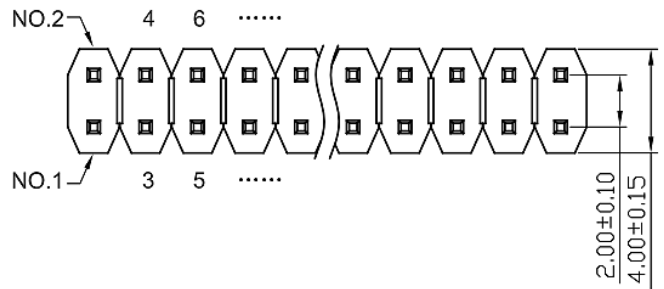
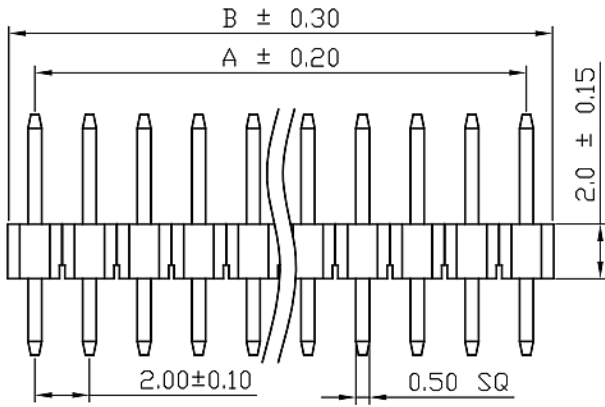

PCB LAYOUT

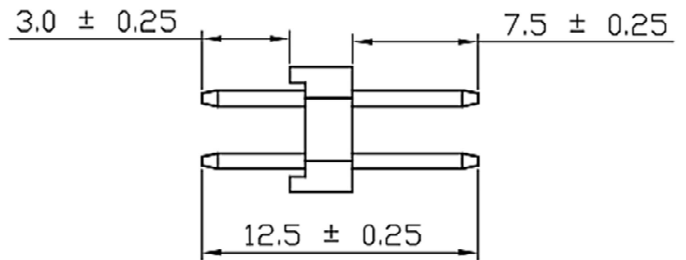

Dimension antitheses list

Item	A	B	L	PA	PC	H
Standard			8.70	3.90	2.80	2.00



No. of Ways	DIM A	DIM B
1	----	2.0
2	2.0	4.00
3	4.00	6.00
4	6.00	8.00
5	8.00	10.0
6	10.0	12.0
7	12.0	14.0
8	14.0	16.0
9	16.0	18.0
10	18.0	20.0
11	20.0	22.0
12	22.0	24.0
13	24.0	26.0
14	26.0	28.0
15	28.0	30.0
16	30.0	32.0
17	32.0	34.0
18	34.0	36.0
19	36.0	38.0
20	38.0	40.0
21	40.0	42.0
22	42.0	44.0
23	44.0	46.0
24	46.0	48.0
25	48.0	50.0
26	50.0	52.0
27	52.0	54.0
28	54.0	56.0
29	56.0	58.0
30	58.0	60.0
31	60.0	62.0
32	62.0	64.0
33	64.0	66.0
34	66.0	68.0
35	68.0	70.0
36	70.0	72.0
37	72.0	74.0
38	74.0	76.0
39	76.0	78.0
40	78.0	80.0



> REVISION HISTORY

Revision	Description	Date
1.0	Initial Drawing Release	04.04.2019

Revision History provided is for informational purposes only and is believed to be accurate.