

MPSI CONNEX USB 2.0 Connectors, 604 Series:

Order Code 604-0002 (See > Options) – Type A Recept, Dual Port, Vertical, TH, UL94V-0



Images are for Illustrative Purposes Only

USB 2.0 Standard. Type A, Dual Port Vertical Through-Hole PCB Mount Receptacle.

Gold (1 Micron) Plated Contacts (*See > Options*)
Tin Plated Solder Tails and Nickel Plated Shell.

Current Rating 1.5A. Copper Alloy Shell.
White PBT Insulator as Standard (*See > Options*).

Mates with USB 2.0 Type A Male Cables.
Backward Compatible with USB 1.1. Supplied in Tray Packaging.

Equivalent to Wurth 614008235023

> TECHNICAL SPECIFICATION

NUMBER OF PORTS:	2
CONNECTOR TYPE:	USB 2.0 TYPE A RECEPTACLE
MOUNTING TYPE:	PCB THROUGH-HOLE
ORIENTATION:	VERTICAL
BODY HEIGHT:	17.00MM
INSULATION (PLASTICS):	PBT WHITE/BLK UL94V-0 (<i>See > Options</i>)
CONTACT MATERIAL:	COPPER ALLOY
CONTACT PLATING:	1 MICRON (u") GOLD OVER NICKEL (<i>See > Options</i>)
SHELL MATERIAL:	COPPER ALLOY
SHELL PLATING:	NICKEL
SOLDER TAILS:	TIN
RoHS COMPLIANT:	EU RoHS 2011/65/EU and EU 2015/863
CURRENT RATING:	1.5A
VOLTAGE RATING:	30V DC
CONTACT RESISTANCE:	30 mΩ MAX
DIELECTRIC WITHSTANDING VOLTAGE:	500V AC
INSULATION RESISTANCE:	1000MΩ
OPERATING TEMPERATURE:	-25°C to +70°C
MATING FORCE (MAX):	2.5kgf
UNMATING FORCE (MAX):	0.8-2.0kgf
DURABILITY:	1500 MATING CYCLES

> PHYSICAL

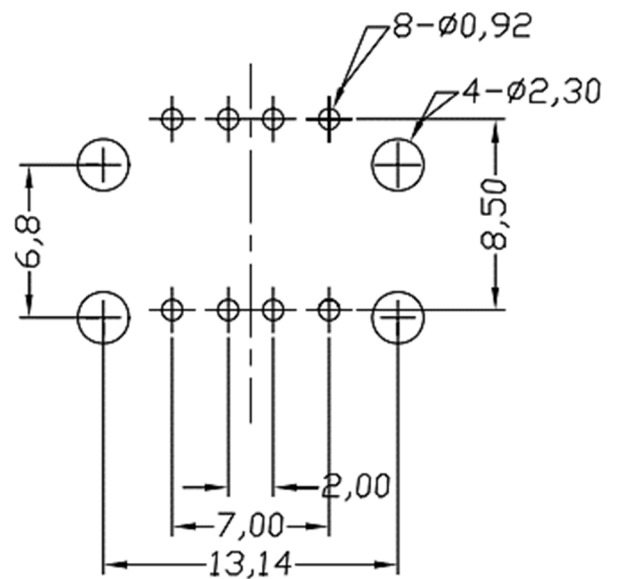
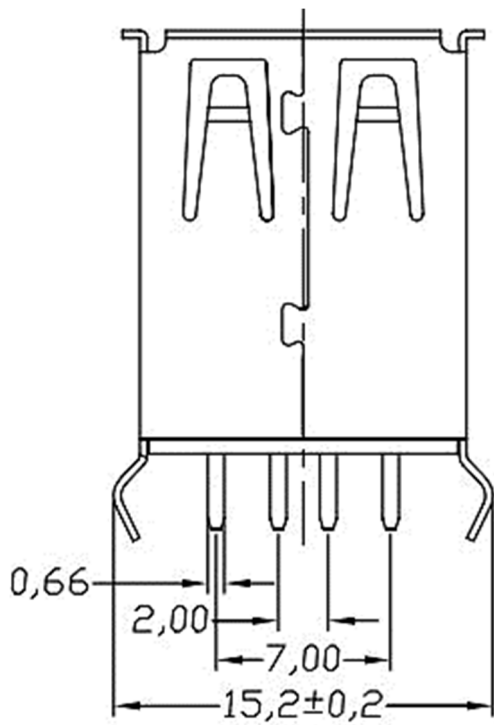
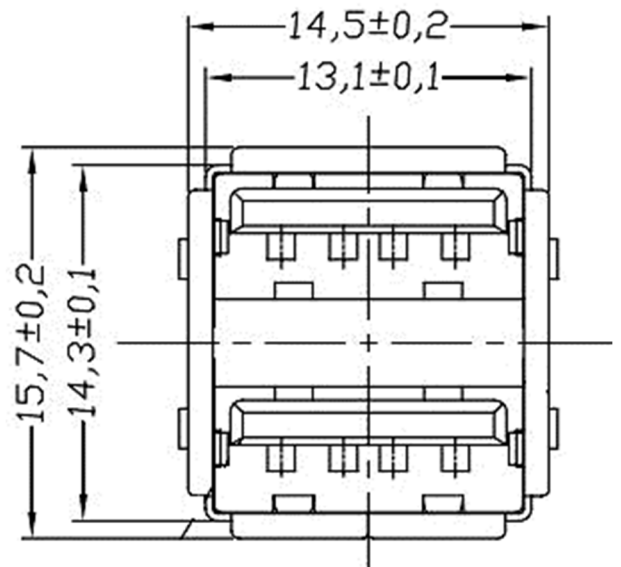
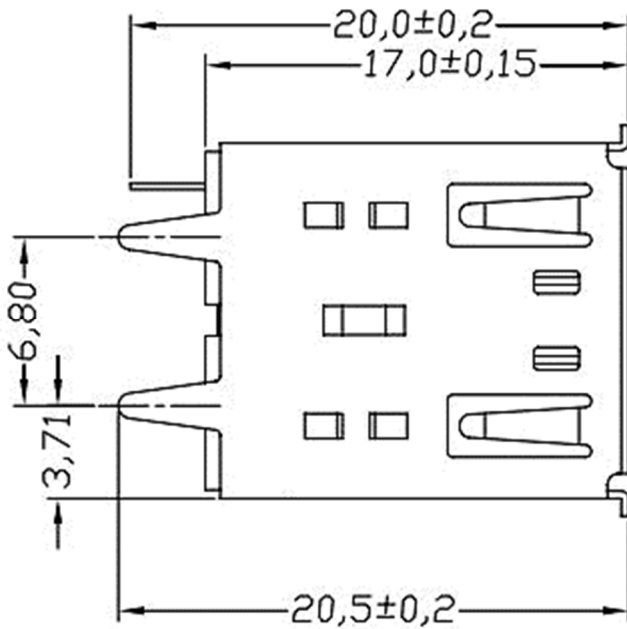

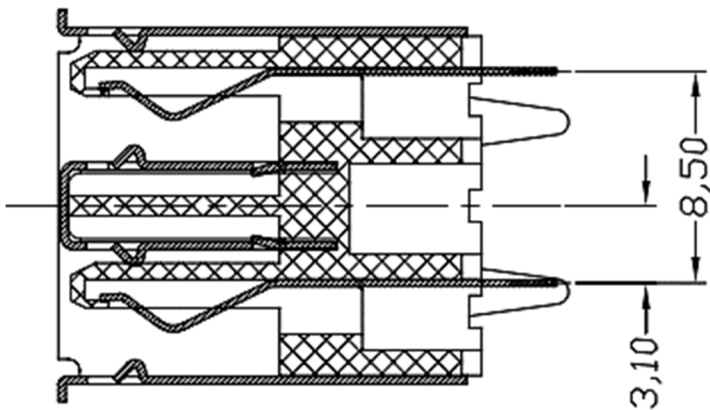



> PART OPTIONS:

INSULATOR COLOUR:
(WHITE AS STD NO SUFFIX)

-B SUFFIX DESIGNATES BLACK

INSULATOR MATLS:
(PBT AS STD NO SUFFIX)

-D SUFFIX DESIGNATES LCP (UL94V-0) HI-TEMP

CONTACT PLATING:
(GOLD FLASH 1U" AS STANDARD NO SUFFIX)

-3 3U" GOLD
-6 6U" GOLD
-15 15U" GOLD
-30 30U" GOLD
-50 50U" GOLD

PART NUMBER EXAMPLE: 604-0002-B = COPPER ALLOY SHELL, BLACK INSULATOR, 1U" GOLD FLASH.
PLEASE VERIFY AVAILABILITY ON OPTIONS PRIOR TO SELECTION / ORDERING

> REVISION HISTORY

Revision	Description	Date
1.0	Initial Drawing Release	31.07.2023

Revision History provided is for informational purposes only and is believed to be accurate.

